

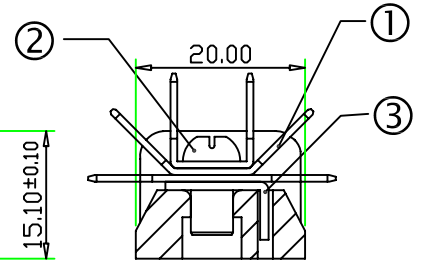

HOWDER

Phenolic type terminal block

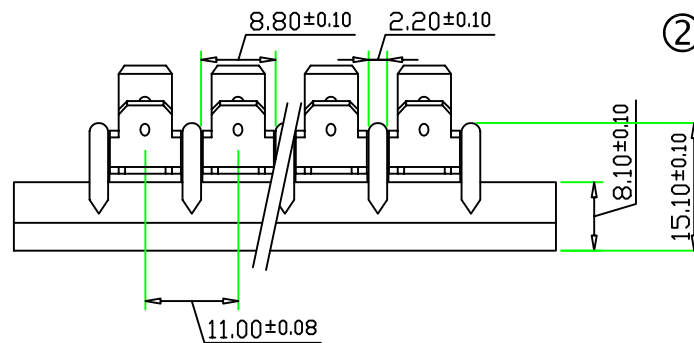
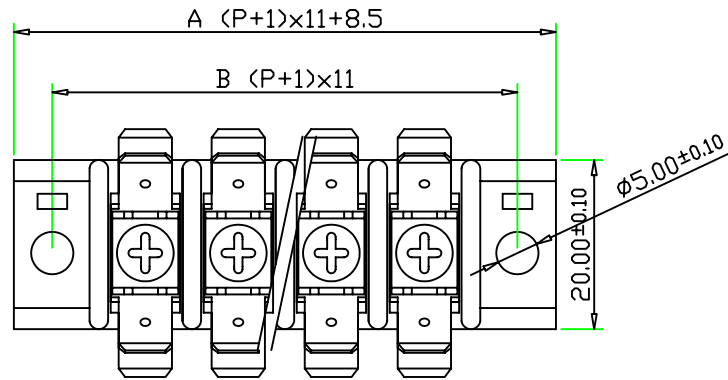

Part Number:

HD-320-PH

Pole Size 2~24P

SPECIFICATIONS

- ① Housing Material: Phenolic , Black
- ② Screw: M4.0 Nickel Plated Steel
- ③ Terminals: Tin Plated Brass

Screws Torque: 9 In-Lb

Wire Range: 12~18 WG

Rated: 20 Amperes.AC250V

Operation Temperature: -55°C~+150°C

Insulation withstands volt: AC2000V min

Insulation resistance: >1000MΩ or more at DC500v