

1210 Inner Lens Bi-Color SMD LED

VS L7378

Description

This is Bi-Color SMD LED series with dimension 3.0 mm (L) * 2.5 mm (W) * 1.5 mm (H). The unique of these LEDs are made from AlGaInP chips that provide high luminous intensity at low driving current. The lens design provides 60 degree viewing angle and suitable for backlighting purpose. The available colors are Blue/Yellow, Yellow/Red or even Red/Blue. Any color combinations specified by customers can be accepted.

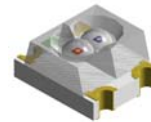



Applications

- Industrial control systems signal indicator
- Automotive features
- Front panel indicator
- Status indication



Electronic Optical Characteristics (at 20mA):

Part Number	Emitted Color	λ (nm)		Iv(mcd)		VF(Volt)		View Angle	Lens
		λd	λp	Min	Typ.	Typ.	Max.		
VS L7378	Red 	624	632	280	500	2.0	2.4	60	Clear
	True-green 	518	525	450	900	2.0	2.4		

Absolute Maximum Ratings (at Ta=25°C)

Emitted Color	P _D (mW)	I _F (mA)	I _{FP} (mA)	I _{R@VR=5V}	Topr(°C)	Tstg(°C)
True-green	90	25	60*	50	-40~+85	-40~+90
Red	60	25	60*	10	-40~+85	-40~+90

Note: Please take note the Absolute Maximum Rating values. Any operation beyond the specified ratings in this table will result degradation of LED life-span and may cause LED to fail.

* Peak forward current (duty 1/10 at 1KHz)

Package Dimension:

unit:mm

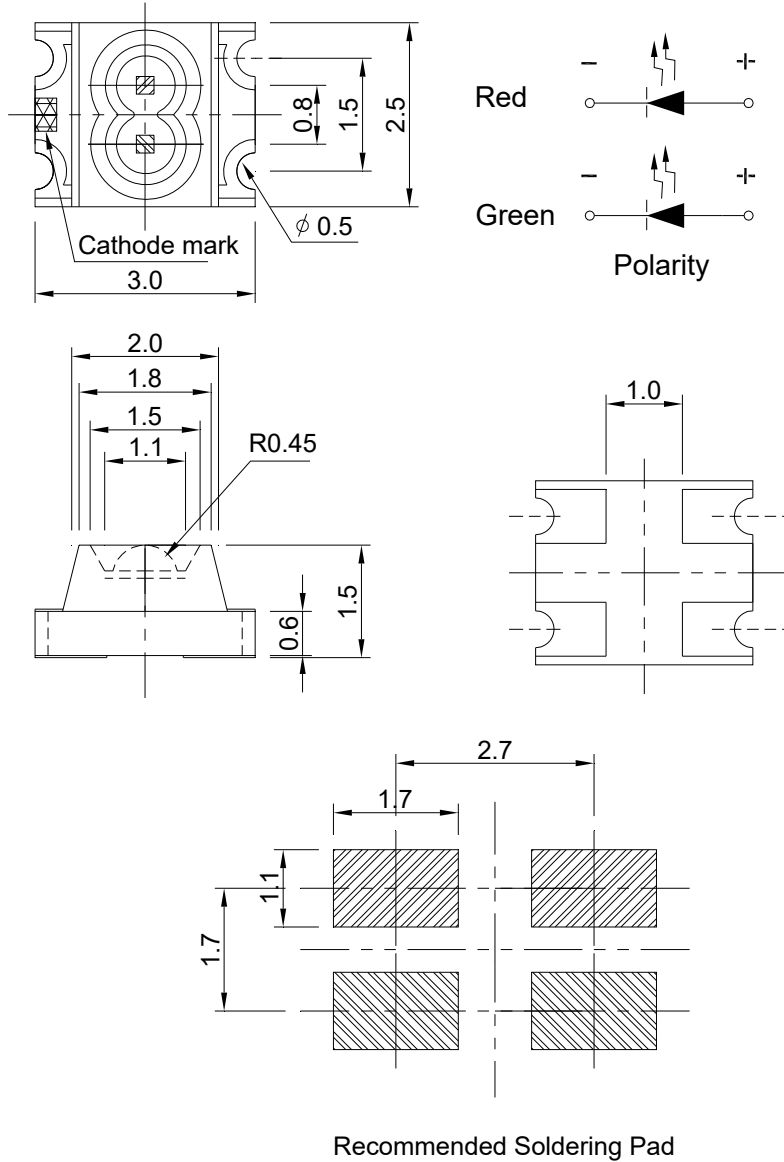
Notes:

1. All dimensions are millimeters.
2. Tolerance is ± 0.2 mm unless otherwise specified
3. Specifications are subject to change without notice.

Optical Characteristics Curves

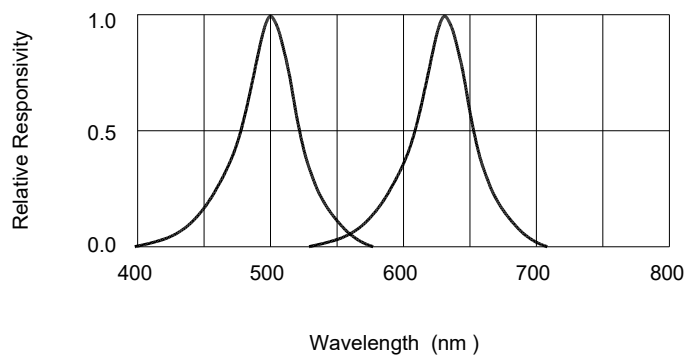
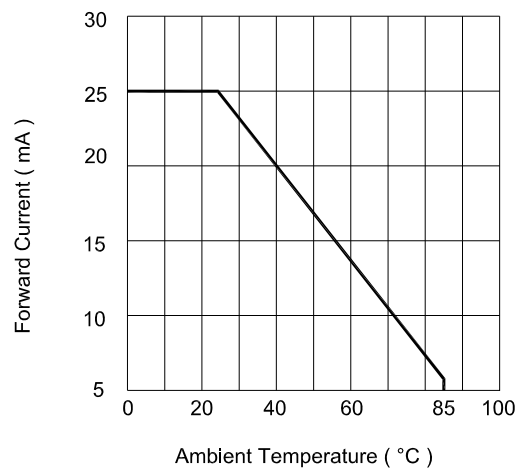
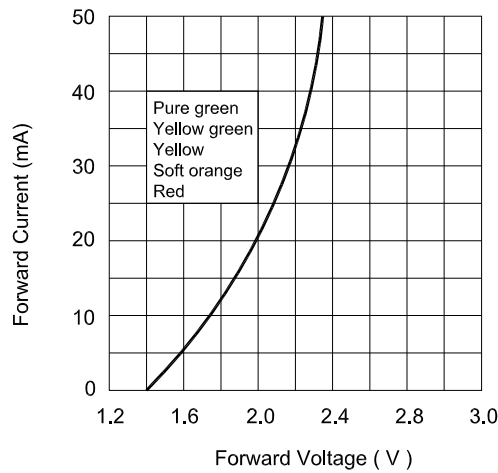
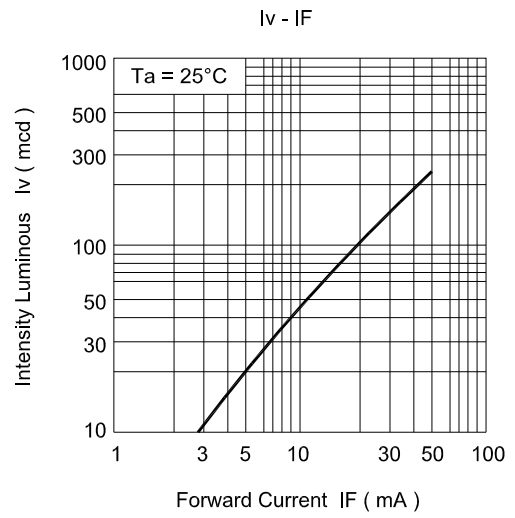
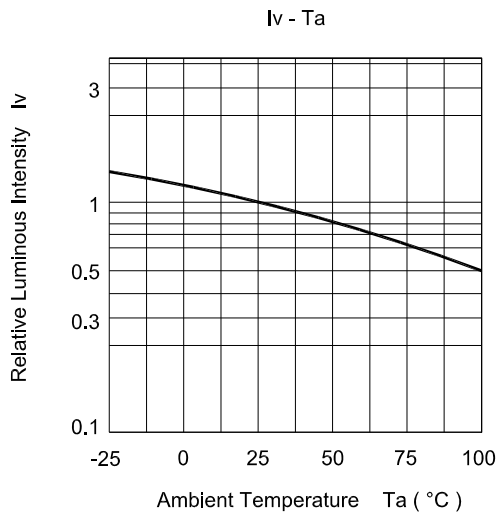

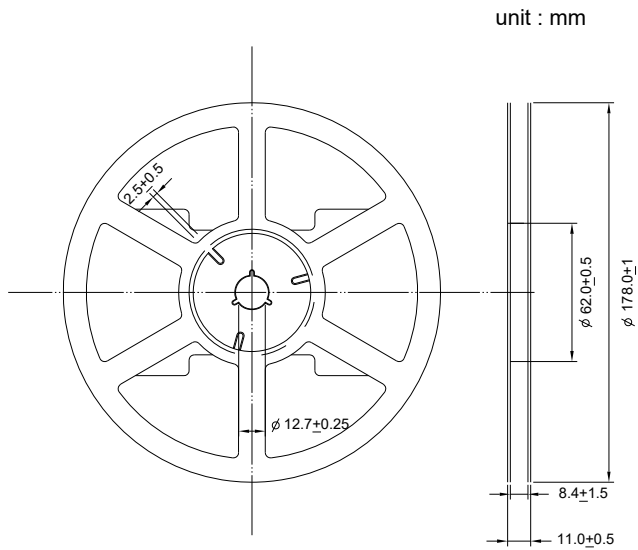
Reel Dimension:

Note:

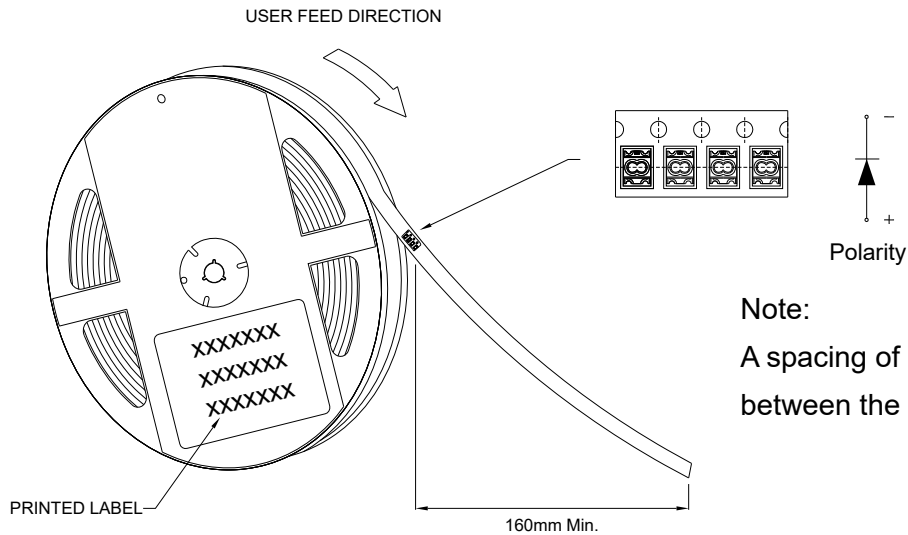
Available in 8mm carrier tape on 178mm diameter reels. (2000 pieces)

Note:

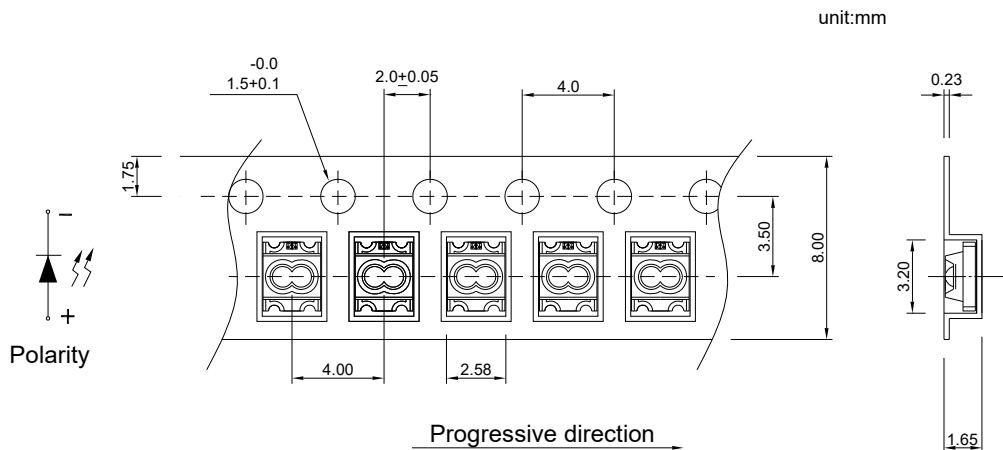
A spacing of approximately 160mm between the front edge of tape

Tape Dimension:

Recommended re-flow soldering profile:

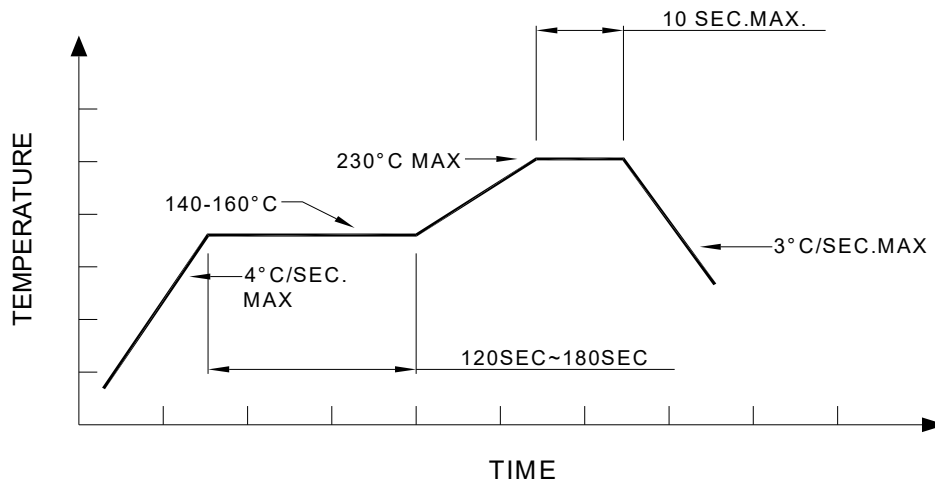

Recommended Pb-free re-flow soldering profile:

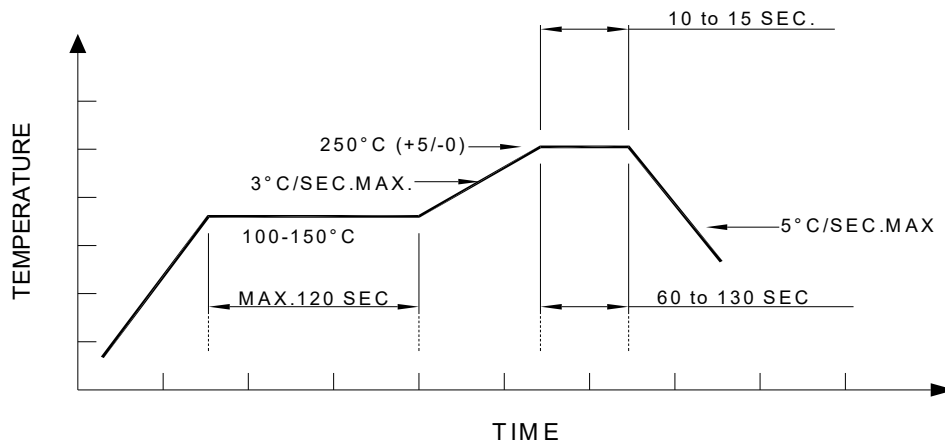

Note:

All the specifications listed in this data sheet are suitable for general electronic equipment, office equipment and communication devices. Kindly consult Sales Representatives for specific reliabilities request, Forward Voltage, Luminous Intensity, Wavelength, Radiant Power or Viewing Angle.