

VER.	REVISED DESCRIPTION	DATE	NAME
1.0	New Release	2016-11-21	
2.0	Modify the brightness, FPC & DST design	2016-12-22	

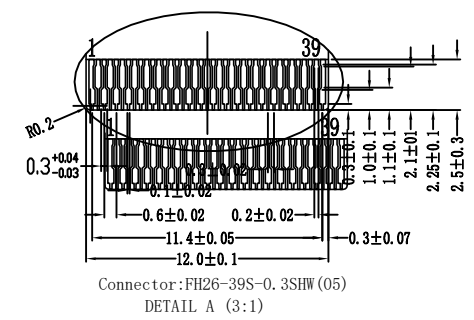
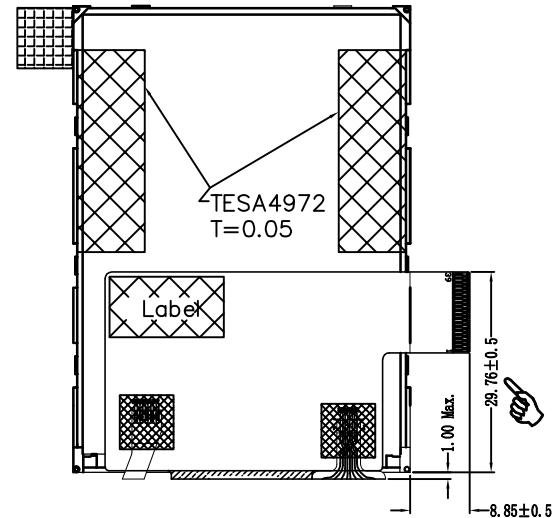
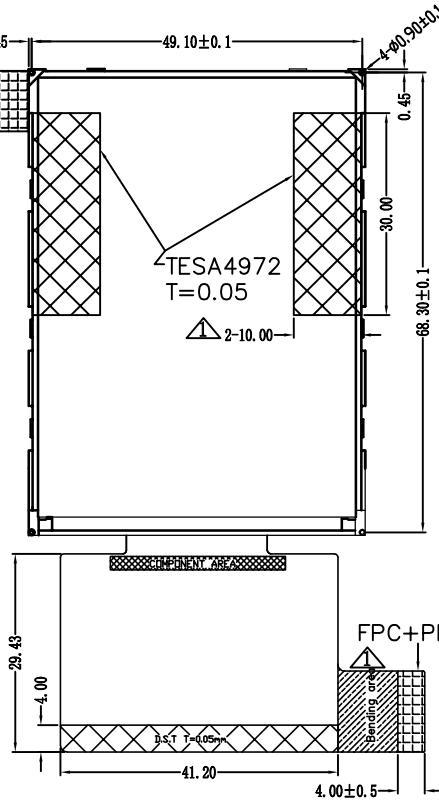
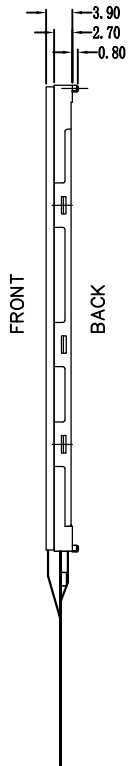
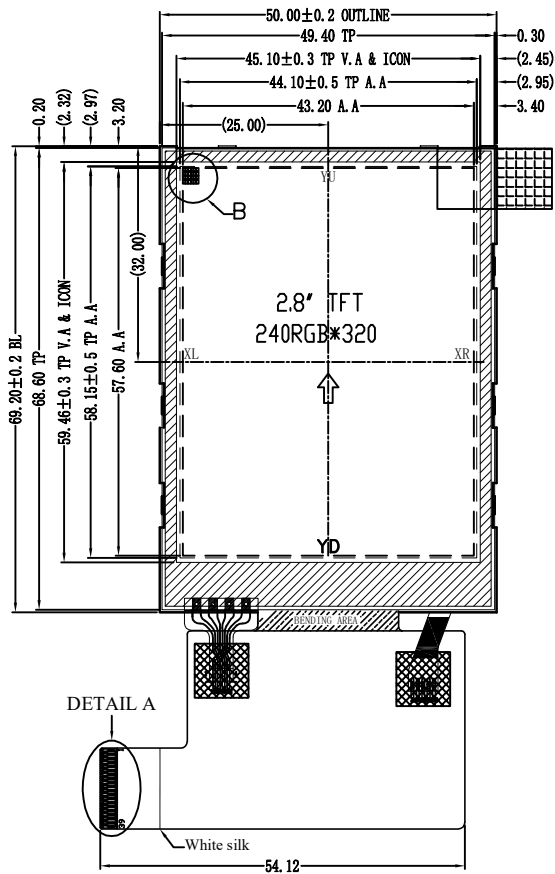

PIN ASSIGNMENT:

No.	PIN NAME
1	VDD
2	VDDI
3	RESET
4	CS
5	RS
6	WR
7	RD
8	GND
9	NC
10	NC
11	DB0
12	DB1
13	DB2
14	DB3
15	DB4
16	DB5
17	DB6
18	DB7
19	DB8
20	DB9
21	DB10
22	DB11
23	DB12
24	DB13
25	DB14
26	DB15
27	DB16
28	DB17
29	LED A
30	LEDK1
31	LEDK2
32	LEDK3
33	LEDK4
34	GND
35	XR
36	XL
37	YU
38	YD
39	NC

LED CIRCUIT DIAGRAM:

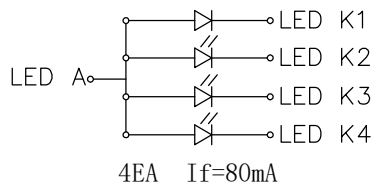

- NOTES:
1. DISPLAY TYPE: 2.83" TFT, TRANSMISSIVE
  2. VIEWING DIRECTION : 6:00 o'clock
  3. Driver IC : ILI9341V
  4. Top : -20° C ~ 70° C, Tst : -30° C ~ 80° C
  5. GENERAL TOLERANCE: ±0.2mm
  6. LCM Luminance: LED/280cd/m (Typical)

DLC Display Co., Limited  
www.dlcdisplay.com

DRAWN BY:	TITLE: DLC0283QZC-T	
CHECKED BY:	DWG NO:	
APPROVED BY:	DWG NAME:	UNIT: mm
CONFIRMED BY:	SHEET NO: OF	