

# NUT RANGE CATALOGUE



# INDEX

Stainless T304

Stainless T316

BMA

Galvanised

Zinc Plated

Plain



**Hex Nuts**

Pg 4 - 8

---



**Hex Lock Nuts**

Pg 9

---



**Hex Nyloc Nuts**

Pg 10 - 11

---



**Dome Nuts**

Pg 12

---



**Wing Nuts**

Pg 13

---



**Flange Nuts - Serrated**

Pg 14

---

# INDEX

Stainless T304

Stainless T316

BMA

Galvanised

Zinc Plated

Plain



## Flange Nuts

Pg 14

---



## 4 Prong Tee Nuts

Pg 15

---



## Pressed Nuts

Pg 16

---



## Square Pressed Nuts

Pg 17

---



## Hank Bush

Pg 18

---



## Castle Nuts

Pg 19

---

# HEX NUT

## Hex Nut

### DIN 934

Stainless T304	
Item number	Description

45S2	M2
45S25	M2.5
45S3	M3
45S4	M4
45S5	M5
45S6	M6
45S8	M8
45S10	M10
45SM12	M12
45SM14	M14
45S16	M16
45S20	M20
45S24	M24
45S30	M30

Stainless T316	
Item number	Description

45S2M	M2
45S3M	M3
45S4M	M4
45S5M	M5
45S6M	M6
45S8M	M8
45S10M	M10
45SM12M	M12
45SM14M	M14
45S16M	M16
45S20M	M20
45S22M	M22
45S24M	M24
45S27M	M27
45S30M	M30
45S36M	M36

### AS1112

Galvanised	
Item number	Description

458G	M8
4510G	M10
45M12G	M12
4516G	M16
4520G	M20
4522G	M22
4524G	M24
4530G	M30
4536G	M36
4539G	M39
4542G	M42
4548G	M48

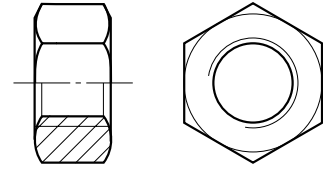

## AS1112

**Zinc Plated**

Item number	Description
452	M2
4525	M2.5
453	M3
454	M4
455	M5
456	M6
458	M8
4510	M10
45M12	M12
45M14	M14
4516	M16
45M18	M18
4520	M20
4524	M24
4527	M27
4530	M30
4536	M36

**Plain**

Item number	Description
456S	M6
458S	M8
4510S	M10
45M12S	M12
45M14S	M14
4516S	M16
45M18S	M18
4520S	M20
4522S	M22
4524S	M24
4527S	M27
4530S	M30
4536S	M36
4542S	M42
4545S	M45
4548S	M48
4552S	M52
4556S	M56
4560S	M60

**Brass**

Item number	Description
45B3	M3
45B4	M4
45B5	M5
45B6	M6
45B8	M8
45B10	M10
45BM12	M12

# HEX NUT cont

## Metric Fine Hex Nut

AS1112

Zinc Plated	
Item number	Description

45HF6	M6 (0.75P)
45HF8	M8 (1.00P)
45HF10	M10 (1.25P)
45HF101	M10 (1.00P)
45HFM121	M12 (1.00P)
45HFM1215	M12 (1.50P)
45HFM12	M12 (1.25P)
45HF16	M16 (1.50P)
45HF20	M20 (1.50P)
45HF2415	M24 (1.50P)
45HF24	M24 (2.00P)

Plain	
Item number	Description

45HF8S	M8 (1.00P)
45HF101S	M10 (1.00P)
45HF10S	M10 (1.25P)
45HFM1215S	M12 (1.50P)
45HFM12S	M12 (1.25P)
45HF14125S	M14 (1.25P)
45HF14S	M14 (1.50P)
45HF161S	M16 (1.00P)
45HF16S	M16 (1.50P)
45HF202S	M20 (2.00P)

Plain	
Item number	Description

45HF20S	M20 (1.50P)
45HF3015S	M30 (1.50P)
45HF30S	M30 (2.00P)
45HF3315S	M33 (1.50P)
45HF362S	M36 (2.00P)
45HF363S	M36 (3.00P)
45HF42S	M42 (3.00P)

## BSW Hex Nut

Zinc Plated	
Item number	Description

4518	1/8
45532	5/32

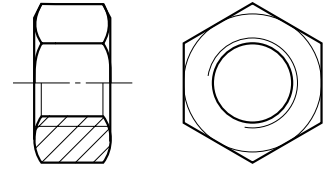

## UNC Hex Nut

### ANSI B18-6.3

#### Stainless T304

Item number	Description
45SC440	4-40
45SC632	6-32
45SC832	8-32
45SC1024	10-24
45SC532	5/32

### ANSI B18-2.2

45SC14	1/4
45SC516	5/16
45SC38	3/8
45SC716	7/16
45SC12	1/2
45SC58	5/8
45SC34	3/4
45SC1	1

### ANSI B18-6.3

#### Stainless T316

Item number	Description
45SC1024M	10-24

### ANSI B18-2.2

45SC14M	1/4
45SC516M	5/16
45SC38M	3/8
45SC716M	7/16
45SC12M	1/2
45SC58M	5/8
45SC34M	3/4
45SC78M	7/8
45SC1M	1
45SC118M	1.1/8
45SC114M	1.1/4
45SC112M	1.1/2

### AS2465

#### Zinc Plated - GR5

Item number	Description
45C14	1/4
45C516	5/16
45C38	3/8
45C716	7/16
45C632	6-32

#### Plain - GR5

Item number	Description
45C14S	1/4
45C516S	5/16
45C38S	3/8
45C716	7/16

### AS2465

#### Zinc Plated - GR8

Item number	Description
45C12	1/2
45C916	9/16
45C58	5/8
45C34	3/4
45C78	7/8
45C1	1
45C118	1.1/8
45C114	1.1/4

#### Plain - GR8

Item number	Description
45C12S	1/2
45C916S	9/16
45C58S	5/8
45C34S	3/4
45C78S	7/8
45C1S	1
45C118S	1.1/8
45C114S	1.1/4
45C138S	1.3/8
45C112S	1.1/2
45C134S	1.3/4
45C2S	2

# HEX NUT cont

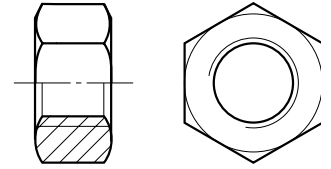

## UNF Hex Nut

### ANSI B18-6.3

#### Stainless T304

Item number	Description
-------------	-------------

45SF1032	10-32
----------	-------

### ANSI B18-2.2

45SF14	1/4
45SF516	5/16
45SF38	3/8
45SF716	7/16
45SF12	1/2
45SF916	9/16
45SF58	5/8

### ANSI B18-6.3

#### Stainless T316

Item number	Description
-------------	-------------

45SF1032M	10-32
-----------	-------

### ANSI B18-2.2

45SF14M	1/4
45SF516M	5/16
45SF38M	3/8
45SF716M	7/16
45SF12M	1/2
45SF34M	3/4
45SF78M	7/8
45SF1M	1

### AS1112

#### Zinc Plated - GR5

Item number	Description
-------------	-------------

45F14	1/4
45F516	5/16
45F38	3/8

#### Plain - GR5

Item number	Description
-------------	-------------

45F14S	1/4
45F516S	5/16
45F38S	3/8

### AS1112

#### Zinc Plated - GR8

Item number	Description
-------------	-------------

45F716	7/16
45F12	1/2
45F916	9/16
45F58	5/8
45F34	3/4
45F78	7/8
45F1	1
45F114	1.1/4

#### Plain - GR8

Item number	Description
-------------	-------------

45F716S	7/16
45F12S	1/2
45F916S	9/16
45F58S	5/8
45F34S	3/4
45F78S	7/8
45F1S	1
45F118S	1.1/8
45F114S	1.1/4
45F112S	1.1/2
45F134S	1.3/4



# LOCK NUT

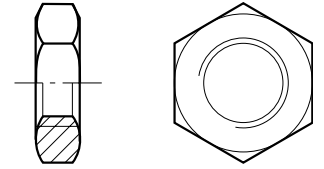

## Lock Nut

### DIN439B

#### Stainless T304

Item number	Description
45LS3	M3
45LS4	M4
45LS5	M5
45LS6	M6
45LS8	M8
45LS10150	M10
45LSM12	M12
45LS16	M16

#### Stainless T316

Item number	Description
45LS6M	M6
45LS8M	M8
45LS10150M	M10
45LSM12M	M12
45LS16M	M16
45LS20M	M20

### ISO 4035

#### Galvanised

Item number	Description
45L12G	M12
45L16G	M16
45L20G	M20
45L24G	M24
45L30G	M30

### ISO 4035

#### Zinc Plated

Item number	Description
45L6ZC	M6
45L8	M8
45L10	M10
45LM12	M12
45LM14	M14
45L16	M16
45L20	M20
45L24	M24
45L30Z	M30

### ANSI B18-2.2

#### Zinc Plated - UNC

Item number	Description
45LC14	1/4
45LC38	3/8
45LC12	1/2

# NYLOC NUT

## Nyloc Nut

### DIN985

Stainless T304		Stainless T316		Galvanised	
Item number	Description	Item number	Description	Item number	Description
45NS25	M2.5	45NS3M	M3	45N8G	M8
45NS3	M3	45NS4M	M4	45N10G	M10
45NS4	M4	45NS5M	M5	45NM12G	M12
45NS5	M5	45NS6M	M6	45N16G	M16
45NS6	M6	45NS8M	M8	45N20G	M20
45NS8	M8	45NS10M	M10	45N24G	M24
45NS10	M10	45NSM12M	M12	45N30G	M30
45NSM12	M12	45NSM14M	M14		
45NS16	M16	45NS16M	M16		
45NS20	M20	45NS20M	M20		
		45NS22M	M22		
		45NS24M	M24		

### DIN985

Zinc Plated		Zinc Plated - Metric Fine	
Item number	Description	Item number	Description
45N25	M2.5	45NM8	M8 (1.00P)
45N3	M3	45NM101	M10 (1.00P)
45N4	M4	45NM10	M10 (1.25P)
45N5	M5	45NM12125	M12 (1.25P)
45N6	M6	45NM1215	M12 (1.50P)
45N8	M8	45NM1415	M14 (1.50P)
45N10	M10	45NM16	M16 (1.50P)
45NM12	M12	45NM1815	M18 (1.50P)
45NM14	M14	45NM20	M20 (1.50P)
45N16	M16	45NM202	M20 (2.00P)
45N20	M20	45NM24	M24 (2.50P)
45N22	M22	45NM242	M24 (2.00P)
45N24	M24	45NM2415	M24 (1.50P)
45N30	M30		

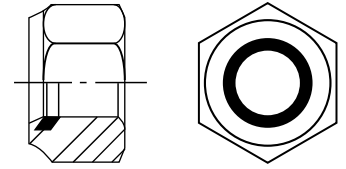

## UNC Nyloc Nut | NM/NE SERIES

Stainless T304	
Item number	Description

45NSC316	3/16
45NSC14	1/4
45NSC516	5/16
45NSC38	3/8
45NS716	7/16
45NSC12	1/2
45NSC58	5/8
45NSC34	3/4

Zinc Yellow GR8	
Item number	Description

45NC12G8	1/2
45NC1G8	1
45NC34G8	3/4
45NC58G8	5/8

Stainless T316	
Item number	Description

45NS316M	3/16
45NSC14M	1/4
45NSC516M	5/16
45NSC38M	3/8
45NSC716M	7/16
45NSC12M	1/2
45NSC58M	5/8
45NSC34M	3/4

Zinc Plated	
Item number	Description

45NC316	3/16
45NC14	1/4
45NC516	5/16
45NC38	3/8
45NC716	7/16
45NC12	1/2
45NC916	9/16
45NC58	5/8
45NC34	3/4
45NC78	7/8
45NC1	1
45NC118	1.1/8
45NC114	1.1/4
45NC112	1.1/2
45NC134	1.3/4
45NC2	2

## UNF Nyloc Nut | NM/NE SERIES

Stainless T304	
Item number	Description

45NSF14	1/4
45NSF516	5/16
45NSF38	3/8
45NSF716	7/16
45NSF12	1/2

Zinc Yellow GR8	
Item number	Description

45NF12G8	1/2
45NF1G8	1
45NF34G8	3/4
45NF58G8	5/8
45NF716G8	7/16

Stainless T316	
Item number	Description

45NSF14M	1/4
45NSF516M	5/16
45NSF38M	3/8
45NSF12M	1/2
45NSF58M	5/8

Zinc Plated	
Item number	Description

45NF316	3/16
45NF14	1/4
45NF516	5/16
45NF38	3/8
45NF716	7/16
45NF12	1/2
45NF916	9/16
45NF58	5/8
45NF34	3/4
45NF78	7/8
45NF1	1
45NF118	1.1/8
45NF114	1.1/4
45NF112	1.1/2
45NF134	1.3/4

# DOME NUT

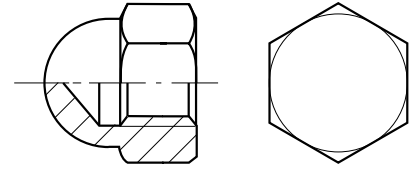

## Dome Nut

DIN1587 - 1 piece

### Stainless T304

Item number	Description
45DS3	M3
45DS4	M4
45DS5	M5
45DS6	M6
45DS8	M8
45DS10	M10
45DSM12	M12
45DS16	M16
45DS20	M20

### Stainless T316

Item number	Description
45DS3M	M3
45DS4M	M4
45DS5M	M5
45DS6M	M6
45DS8M	M8
45DS10M	M10
45DSM12M	M12
45DS16M	M16
45DS20M	M20

### Brass Nickel Plated

Item number	Description
45D3N	M3
45D4N	M4
45D5N	M5
45D6N	M6
45D8N	M8
45D10N	M10

## UNC Dome Nut

DIN1587 - 1 piece

### Stainless T304

Item number	Description
45DS316	3/16
45DS14	1/4
45DS516	5/16
45DS38	3/8

## UNF Dome Nut

DIN1587 - 1 piece

### Stainless T304

Item number	Description
45DSF14	1/4
45DSF516	5/16
45DSF38	3/8
45DSF12	1/2

# WING NUT

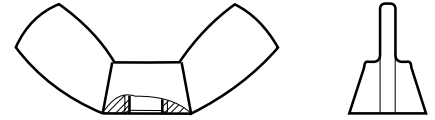

## Wing Nut

### DIN314 - AF

### ANSI B18 .17

#### Stainless T304

#### Stainless T316

#### Zinc Plated

Item number	Description
-------------	-------------

Item number	Description
-------------	-------------

Item number	Description
-------------	-------------

45WS4	M4
45WS5	M5
45WS6	M6
45WS8	M8
45WS10	M10
45WSM12	M12

45WS3M	M3
45WS4M	M4
45WS5M	M5
45WS6M	M6
45WS8M	M8
45WS10M	M10
45WSM12M	M12

45W4	M4
45W5	M5
45W6	M6
45W8	M8
45W10	M10
45WM12	M12

## UNC Wing Nut

#### Stainless T304

#### Stainless T316

Item number	Description
-------------	-------------

Item number	Description
-------------	-------------

45WS316	3/16
45WS14	1/4
45WS516	5/16
45WS38	3/8

45WS14M	1/4
---------	-----

# FLANGE NUT

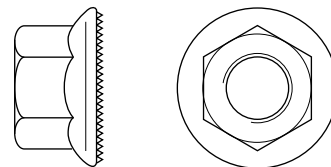

## Flange Nut - Non-Serrated

## Flange Nut - Serrated

DIN6923

### Stainless T304

Item number	Description
45FLS5	M5
45FLS6	M6
45FLS8	M8
45FLS10	M10

### Zinc Plated CL8

Item number	Description
45FL4	M4
45FL5	M5
45FL6	M6
45FL8	M8
45FL10	M10
45FLM12ZC	M12
45FL16	M16

# 4 PRONG TEE NUT

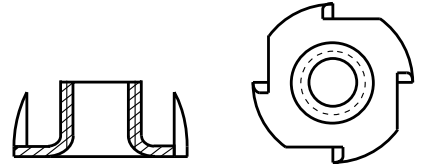

## Tee Nut 4 Prong

### Zinc Plated

Item number	Description
-------------	-------------

45T4U	M4
45T5U	M5
45T6U	M6
45T8U	M8
45T10U	M10

# PRESSED NUT

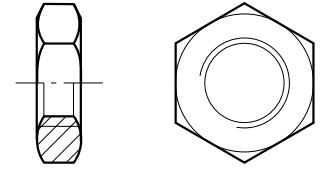

## Pressed Nut

DIN439 - B

### Zinc Plated

Item number	Description
45P3	M3
45P4	M4
45P5	M5
45P6	M6

### Brass

Item number	Description
45PB3	M3
45PB4	M4
45PB5	M5
45PB6	M6
45PB8	M8

## UNC Pressed Nut

ANSI B18 - 6.3

### Zinc Plated

Item number	Description
45P18	1/8
45P532	5/32
45P14	1/4

### Brass

Item number	Description
45PB18	1/8
45PB316	3/16
45PB532	5/32
45PB14	1/4



# SQUARE PRESSED NUT

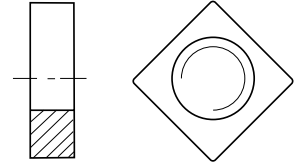

## Square Pressed Nut

DIN562

**Zinc Plated**

Item number	Description
-------------	-------------

45PS3	M3
45PS4	M4
45PS5	M5
45PS6	M6

## UNC Square Pressed Nut

ANSI B18 - 6.3

**Zinc Plated**

Item number	Description
-------------	-------------

45PS632	6-32
45PS532	5/32
45PS316	3/16
45PS14	1/4

# HANK BUSH

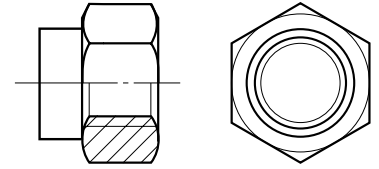

## Hank Bush

Stainless T304	
Item number	Description

45HS3H	M3
45HS4H	M4
45HS5H	M5
45HS6H	M6
45HS10H	M10

Zinc Plated	
Item number	Description

45H3	M3
45H4	M4
45H5	M5
45H6	M6
45H8	M8
45H10	M10
45H12	M12

## Round Hank Bush

Stainless T304	
Item number	Description

45HS5	M5
45HS6	M6
45HS8	M8
45HS10	M10

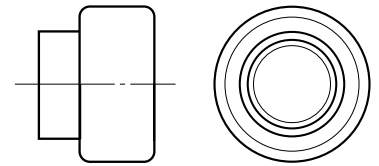

# CASTLE NUT

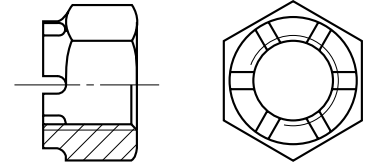

## Castle Nut

### Zinc Plated

Item number	Description
45CA6	M6
45CA10	M10
45CAM14	M14
45CA16	M16
45CA20	M20
45CA24	M24
45CA30	M30

## UNF Castle Nut

### Zinc Plated

Item number	Description
45CAF12	1/2
45CAF58	5/8

**THREAD PITCH IDENTIFICATION CHART**

Size	Major Dia.		Thread Pitch mm	Size	T.P.I		Major Dia. Inch	T.P.I	
	mm	Inch			UNC	UNF		BSW	BSF
	METRIC PRODUCTS			UNIFIED INCH PRODUCTS			B.S. INCH P.I.		
M1.6	1.60	0.63	0.35	# 0	-	80	0.060		
M2.0	2.00	0.79	0.4	# 1	-	72	0.073		
				# 2	56	64	0.086		
M2.5	2.50	0.98	0.45	# 3	48	56	0.099		
				# 4	40	48	0.112		
M3	3.00	0.118	0.5	# 5	40	44	0.125	40	
				# 6	32	40	0.138		
M4	4.00	0.157	0.7	# 8	32	36	0.164		
M5	5.00	0.197	0.8	# 10	24	32	0.190	24	32
M6	6.00	0.235	1.0	1/4	20	28	0.250	20	26
M8	8.00	0.315	1.25	5/16	18	24	0.313	18	22
M10	10.00	0.394	1.5	3/8	16	24	0.375	16	20
				7/16	14	20	0.438	14	18
M12	12.00	0.472	1.75	1/2	13	20	0.500	12	16
M14	14.00	0.551	2.0						
M16	16.00	0.630	2.0	5/8	11	18	0.625	11	14
M20	20.00	0.787	2.5	3/4	10	16	0.750	10	12
				7/8	9	14	0.875	9	11
M24	24.00	0.945	3.0	1	8	12	1.000	8	10
				1.1/8	7	12	1.125	7	9
M30	30.00	1.181	3.5	1.1/4	7	12	1.250	7	9
M36	36.00	1.417	4.0	1.1/2	6	12	1.500	6	8
M42	42.00	1.654	4.5						

**THREAD PITCH IDENTIFICATION CHART**

Size	Pitch I.S.O. Coarse	Pitch I.S.O Fine	Size	T.P.I	
				UNC	UNF
METRIC PRODUCTS			UNIFIED INCH PRODUCTS		
M1.6	0.35	-	0	-	80
M2	0.40	-	1	-	72
M2.5	0.45	-	2	56	64
M3	0.50	0.35	3	48	56
M4	0.70	0.50	4	40	48
M5	0.80	0.50	5	40	44
M6	1.00	0.75	6	32	40
M7	1.00	0.75	8	32	36
M8	1.25	1.00	10	24	32
M10	1.50	1.25 (1.0)			
M12	1.75	1.25 (1.5)	1/4	20	28
M14	2.00	1.50	5/16	18	24
M16	2.00	1.50	3/8	16	24
M18	2.50	1.50	7/16	14	20
M20	2.50	1.50	1/2	13	20
M22	2.50	1.50	9/16	12	18
M24	3.00	2.00	5/8	11	18
M27	3.00	2.00	3/4	10	16
M30	3.50	2.00	7/8	9	14
M33	3.50	3.00	1	8	12
M36	4.00	3.00	1.1/8	7	12
M42	4.50	3.00	1.1/4	7	12
M48	5.00	3.00	1.1/2	6	12
M56	5.50	4.00	2	4.5	-
M64	6.00	4.00	2.1/2	4	-
M72	6.00	-	3	4	-



We reserve the right to conduct product changes which, in our view, serve to improve quality at any time with or without notice. Images displayed may differ in appearance from the delivered product. Therefore we reserve the right for printing errors and assume no liability. These are our general terms and conditions.