

△ SPECIFICATION

- 1. Material & Finish:
Housing: LCP (UL94V-0), Besss
Actuator: LCP (UL94V-0), Black
Contact: Phosphor Bronze, Tin Plated Over Nickel
Leg: Brass, Tin Plated Over Nickel
- 2. Electrical Characteristics:
Operation Voltage: 50V Max.
Current Rating: 0.4A AC/DC
- 3. Environmental Characteristics:
Operation Temperature: -25°C ~ +85°C
- 4. RoHS Compliant

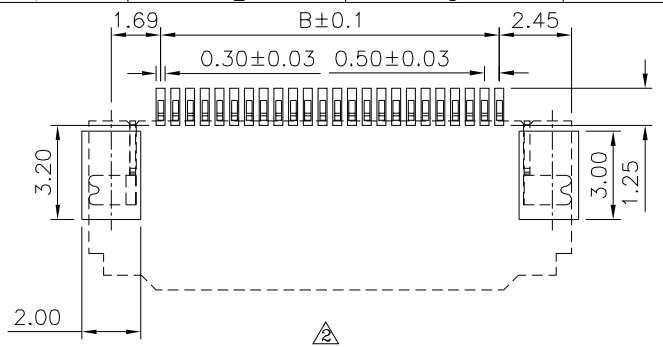

Recommended P.C.B. Layout

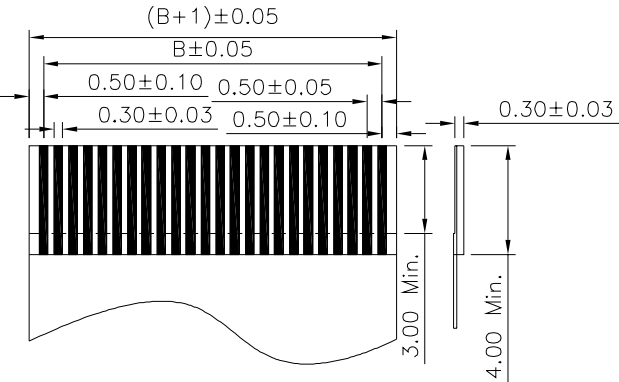

Recommended FPC Dimension

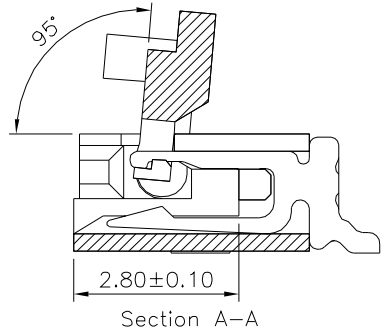
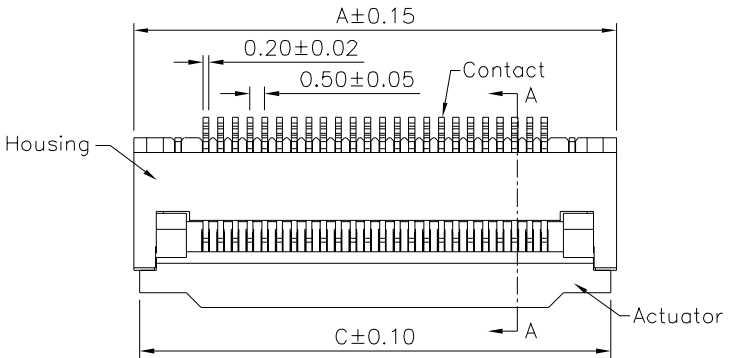

Section A-A

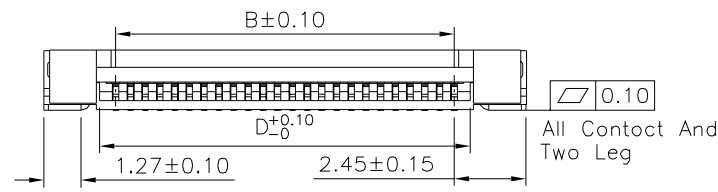

FPC Slot Dimension

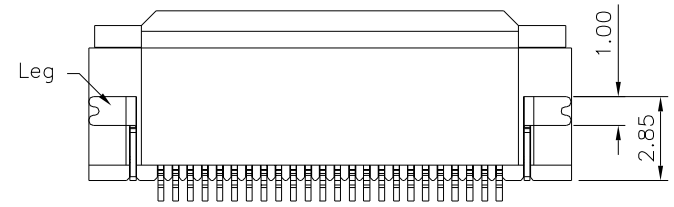
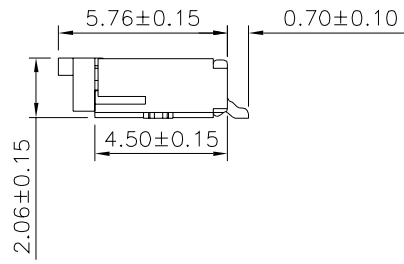

Pin	A	B	C	D	Pin	A	B	C	D
*04	6.40	1.50	6.00	2.50	*43	25.90	21.00	25.50	22.00
*05	6.90	2.00	6.50	3.00	*44	26.40	21.50	26.00	22.50
*06	7.40	2.50	7.00	3.50	*45	26.90	22.00	26.50	23.00
*07	7.90	3.00	7.50	4.00	*46	27.40	22.50	27.00	23.50
*08	8.40	3.50	8.00	4.50	*47	27.90	23.00	27.50	24.00
*09	8.90	4.00	8.50	5.00	*48	28.40	23.50	28.00	24.50
*10	9.40	4.50	9.00	5.50	*49	28.90	24.00	28.50	25.00
*11	9.90	5.00	9.50	6.00	*50	29.40	24.50	29.00	25.50
*12	10.40	5.50	10.00	6.50	*51	29.90	25.00	29.50	26.00
*13	10.90	6.00	10.50	7.00	*52	30.40	25.50	30.00	26.50
*14	11.40	6.50	11.00	7.50	*53	30.90	26.00	30.50	27.00
*15	11.90	7.00	11.50	8.00	*54	31.40	26.50	31.00	27.50
*16	12.40	7.50	12.00	8.50	*55	31.90	27.00	31.50	28.00
*17	12.90	8.00	12.50	9.00	*56	32.40	27.50	32.00	28.50
*18	13.40	8.50	13.00	9.50	*57	32.90	28.00	32.50	29.00
*19	13.90	9.00	13.50	10.00	*58	33.40	28.50	33.00	29.50
*20	14.40	9.50	14.00	10.50	*59	33.90	29.00	33.50	30.00
*21	14.90	10.00	14.50	11.00	*60	34.40	29.50	34.00	30.50
*22	15.40	10.50	15.00	11.50	61	34.90	30.00	34.50	31.00
*23	15.90	11.00	15.50	12.00	62	35.40	30.50	35.00	31.50
*24	16.40	11.50	16.00	12.50	63	35.90	31.00	35.50	32.00
*25	16.90	12.00	16.50	13.00	64	36.40	31.50	36.00	32.50
*26	17.40	12.50	17.00	13.50	65	36.90	32.00	36.50	33.00
*27	17.90	13.00	17.50	14.00	66	37.40	32.50	37.00	33.50
*28	18.40	13.50	18.00	14.50	67	37.90	33.00	37.50	34.00
*29	18.90	14.00	18.50	15.00	*68	38.40	33.50	38.00	34.50
*30	19.40	14.50	19.00	15.50	69	38.90	34.00	38.50	35.00
*31	19.90	15.00	19.50	16.00	70	39.40	34.50	39.00	35.50
*32	20.40	15.50	20.00	16.50	71	39.90	35.00	39.50	36.00
*33	20.90	16.00	20.50	17.00	72	40.40	35.50	40.00	36.50
*34	21.40	16.50	21.00	17.50	73	40.90	36.00	40.50	37.00
*35	21.90	17.00	21.50	18.00	74	41.40	36.50	41.00	37.50
*36	22.40	17.50	22.00	18.50	75	41.90	37.00	41.50	38.00
*37	22.90	18.00	22.50	19.00	76	42.40	37.50	42.00	38.50
*38	23.40	18.50	23.00	19.50	77	42.90	38.00	42.50	39.00
*39	23.90	19.00	23.50	20.00	78	43.40	38.50	43.00	39.50
*40	24.40	19.50	24.00	20.50	79	43.90	39.00	43.50	40.00
*41	24.90	20.00	24.50	21.00	*80	44.40	39.50	44.00	40.50
*42	25.40	20.50	25.00	21.50					

The Mark Of "*" Are Toolled

4UCON 元化興業股份有限公司
4UCON TECHNOLOGY INC.

DRAWING No.		APPROVED BY		UNLESS OTHERWISE SPECIFIED TOLERANCES ARE .X ±0.25 .XX ±0.20 .XXX ±0.10
19789		MEI		
		HZF		
SCALE		REV.		UNIT
NONE		B2		mm

△ B2	Modify Data	HZF	09/06/2021
△ B1	Modify Data	HZF	05/27/2019
△ B0	NEW RELEASE	HZF	05/30/2018
NO. REV.	REVISIONS	CHK	DATE